

86TH ANNUAL CONGRESS  
OF THE SWISS SOCIETY OF PATHOLOGY

«From Tradition to Future»

**12.-14.11.2020**

kultur &  
kongresshaus aarau

**WEARING A MASK  
IS COMPULSORY  
IN THE KONGRESSHAUS KUK**

**Program**

**SGPath SSPath**

SOCIÉTÉ SUISSE DE PATHOLOGIE  
SCHWEIZERISCHE GESELLSCHAFT FÜR PATHOLOGIE  
SWISS SOCIETY OF PATHOLOGY

Online registration [www.meeting-com.ch/Conferences&Meetings](http://www.meeting-com.ch/Conferences&Meetings)

# Table of content

Roche

Welcome	4-
Organization	
Concept protection COVID	8-
General information	10-1
Program at a glance	13-1
Program Thursday, November	16-1
Program Friday, November	19-2
Program Saturday, November	2
Speakers	23-2
Co-sponsors	26-2
Exhibition	
Sponsored lectures	
Kind thanks to all our sponsors	
Save the date 2021	

# Willkommen

Liebe Kolleginnen und Kollegen!

Herzlich willkommen zur 86. Jahrestagung der Schweizerischen Gesellschaft für Pathologie in Aarau! Dieses Jahr steht unter besonderen Bedingungen, die uns alle wahrlich Bewährtem in eine neue Zeit bringen. Die uns täglich beschäftigende SARS-CoV 2 Pandemie hat unseren Alltag nachhaltig verändert und so manch eine neue Idee oder Innovation ist daraus entstanden. Aus diesem Grund ist das diesjährige Kongressmotto «From tradition to future» ein Leitmotiv für das sich geänderte private und fachliche Weltbild.

Für die Veranstaltung haben wir alle Schutzkonzepte sorgfältig erarbeitet und werden die gesetzlichen Vorgaben erfüllen, sodass wir nach langer Zeit wieder die Gelegenheit haben uns persönlich auszutauschen. COVID-19 wird ein Schwerpunkt sein und ich freue mich, dass wir den ehemaligen Leiter der Abteilung «Übertragbare Krankheiten» des BAG, Daniel Koch, gewinnen konnten, der uns die Sichtweise aus der politischen und administrativen Ebene näherbringen wird.

Weitere Schwerpunkte werden die Digitalisierung unseres Faches, die Uropathologie, die Knochenmarkpathologie, und die Weichgewebs- und Knochenpathologie sein, zu welcher in diesem Jahr die neue WHO Klassifikation erschienen ist. Im Schnittseminar am Samstag werden wir Fälle diskutieren, welche im Gedächtnis geblieben sind, und aus denen wir für die Zukunft viel mitgenommen haben.

Am Gala Dinner wird uns Herr Dr. med. Fabian Unteregger mit viel Humor dazu verleiten, die besondere Lage mit anderen Augen zu sehen und uns zu neuen Inspirationen verhelfen.

Wir freuen uns auf ein Wiedersehen in Aarau.

Blieben Sie gesund!



Prof. Dr. R. Grobholz  
Kongresspräsident

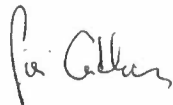

Prof. Dr. G. Cathomas  
Präsident SGPath

# Bienvenue

Chères et Chers Collègues,

Bienvenue à la 86<sup>e</sup> conférence annuelle de la Société Suisse de Pathologie à Aarau. Cette année se déroule dans des conditions particulières, qui nous font passer de l'ancien à une nouvelle époque. La pandémie de SRAS-CoV 2, à laquelle nous sommes confrontés chaque jour, a changé notre vie quotidienne à jamais, et de nombreuses idées ou innovations en ont résultés. C'est pourquoi la devise du congrès de cette année, «De la tradition à l'avenir», est un leitmotiv pour la nouvelle vision du monde privé et professionnel.

Pour cet événement, nous avons soigneusement élaboré tous les concepts de protection et nous nous conformerons aux exigences légales, de sorte que nous aurons l'occasion d'échanger à nouveau nos expériences personnelles après un long moment. La maladie COVID-19 sera un point de convergence, et je suis heureux que nous ayons pu faire appel aux services de M. Daniel Koch, ancien Chef de la division «Maladie transmissibles» de l'OFSP, qui nous permettra de comprendre leur point de vue politique et administratif.

Les autres domaines principaux seront la numérisation de notre spécialité, l'Uropathologie, la Pathologie de la moelle osseuse, et la Pathologie des tissus mous et de os, pour laquelle la nouvelle classification de l'OMS a été publiée cette année. Lors du séminaire de samedi, nous discuterons des cas dont nous nous sommes souvenus et dont nous avons beaucoup appris pour l'avenir.

Lors du dîner de gala, le docteur Fabian Unteregger fera preuve de beaucoup d'humour pour nous faire voir cette situation particulière avec des yeux différents, et nous aider à trouver de nouvelles inspirations.

Nous nous réjouissons de vous revoir à Aarau.

Prenez soin de vous!

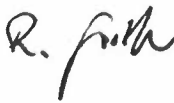

Prof. Dr. R. Grobholz  
Président du Congrès

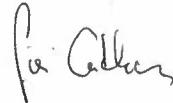

Prof. Dr. G. Cathomas  
Président SSPATH

# ONCOGENIC ALTERATIONS IN NSCLC

Oncogenic alterations can drive non-small cell lung cancer (NSCLC) development

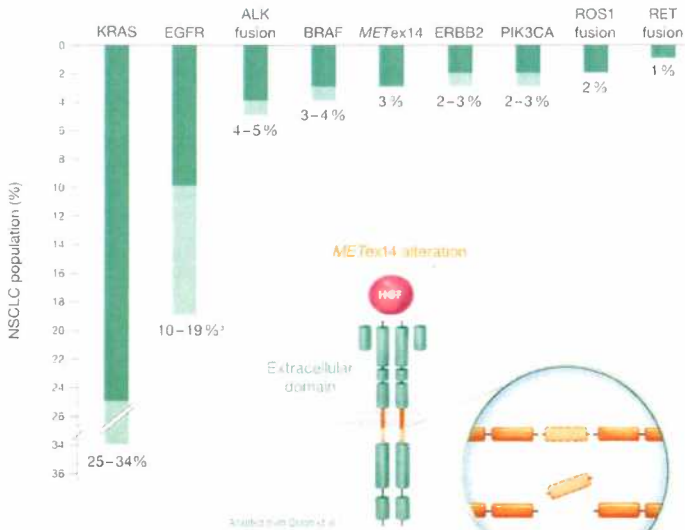

**METex14 alterations result in sustained oncogenic MET signaling, contributing to poor prognosis and highlighting the importance of knowing if your patients have METex14 NSCLC<sup>5,6</sup>**

\* EGFR mutations vary by ethnicity. EGFR mutations may be found in ~31% of Asian patients and 7% to 9% of other ethnic populations.  
 HGF: Hepatocyte growth factor  
 References: 1. NCCN Guidelines Version 3.2020. Non-small-cell lung cancer. 2. Barlesi et al., Routine molecular profiling of patients with advanced non-small-cell lung cancer: results of a 1-year nationwide programme of the French Cooperative Thoracic InterGroup (FCT). *Lancet*. 2019 Apr 2;393(10196):1415-1426. Epub 2019 Jan 15. 3. Awad et al., MET Exon 14 Mutations in Non-Small-Cell Lung Cancer Are Associated With Advanced Age and Stage-Dependent MET-Sensitization and e-Met Overexpression. *J Clin Oncol*. 2016;34(7):721-730. 4. Dizon et al., Targeting MET in Lung Cancer: Will Expectations Finally Be MET? *J Thorac Oncol*. 2017 Jun;12(11):15-26. doi: 10.1016/j.jtho.2016.10.014. Epub 2016 Oct 26. 5. Atyewezysakorn et al., Understanding and Targeting MET Signaling in Solid Tumors - Are We There Yet? *J Cancer* 2016; 7(6):623-643. doi:10.7150/jca.12663.  
 Novartis Pharma Schweiz AG, Hechli, Säurholz 14, 6343 Hohenstein, Switzerland. Tel. 041 763 71 11

**NOVARTIS**

## Organization

### Congress President

Rainer Grobholz, Aarau

### Scientific Committee

Roland Zweifel, Aarau  
 Stefano La Rosa, Lausanne  
 Stefan Dinkhofer, Basel  
 Daniel Baumhauer, Basel  
 Beata Bode-Lesniewska, Zürich  
 Inbi Zlobec, Bern  
 Andrew Janowczyk, Lausanne

### SGPath/SSPath Board

**President**  
 Gen Cathomas, Estel

**Vice President**  
 Alessandro Lugli, Bern

**Secretary**  
 Zsuzsanna Varga, Zürich

**Administration SGPath/SSPath**  
 Alexandra Safret, Neuchâtel

**Quality Management**  
 Joachim Diebold, Lucerne

**Representative Cytopathology**  
 Massimo Bongiovanni, Lausanne

**Representative Training and continuous education**  
 Paul Komminoth, Zürich

**Tariff: DRG, Tarmed**  
 Philip Went, Chur

**Representative Molecular Pathology**  
 Wolfram Jochum, St.Gallen

### Abstract selection committee

Yara Banz, Bern  
 Lukas Büchler, Basel  
 Milo Fratini, Locarno  
 Ekkehard Hoyer, Lausanne  
 Sylvia Höller, Zürich  
 Wolfram Jochum, St.Gallen  
 Kirsten Mertz, Liestal  
 Ellen Obermann, Lucerne  
 Giacomo Pubbo, Geneva  
 Roland Zweifel, Aarau

# Concept protection COVID

## BASIC RULES OF THE PROTECTION PLAN COVID-19

The protection plan ensures that the following requirements are met. For each of these requirements, a number of appropriate measures have been provided for. Here is a short summary, for the whole concept please refer to the whole sanitary concept of the website of meeting.com

### Protective mask and hand hygiene

- Wearing a mask is compulsory at the KuK, in all areas. Protective masks can be obtained if necessary at the Congress reception desk.
- All attendees have been informed not to come in case of COVID-19 prior symptoms.

### Keep your distance

- All congress participants must respect the minimum distance prescribed by the FOPH (1,5 m). If it is not possible, the participants must wear a mask.
- In general, no physical contact (except in a medical emergency);
- Handshakes are to be avoided at all costs.

### Cleaning

- All surfaces with which participants have been in contact will be regularly disinfected;
- Doors should be kept open as much as possible;
- A sufficient and regular ventilation of the rooms will be ensured;
- Dispensers for soap, hand disinfectants, disposable towels and cleaning products (for objects and/or surfaces) will be refilled regularly;
- The KuK has a sufficient number of toilets on the different floors and takes the necessary measures to respect the distances in the toilets, which will be regularly cleaned and disinfected. A cleaning plan will be kept.

### Onsite registration

- Wherever possible, registration and payment of participants is made in advance online;
- On-site registrations will be allowed, according to the hygiene measures in force;
- the secretariat is equipped with Plexiglas to ensure the protection of participants and staff;
- We recommend that participants who have to pay on site to do so by credit card;
- Participants & exhibitors receive their badges on site upon arrival. They are advised to arrive early in order to respect the distances and the wait that this may cause.

### Catering

- There will be 2 separate areas for the catering, which is why the participants are separated in two colours of lanyards, to be kept and not exchanged for tracing reasons;
- All catering is in the form of prepared snacks and/or pre-packed meals (lunch bags);
- Participants will receive their coffee and/or lunch bags at the buffets, and are allowed to remain standing, in the area of the colour of their lanyards, which will be boarded accordingly;
- Exhibitors will be served directly at their booth.

### Conference rooms

- Wearing a mask is mandatory in conference rooms and during all the sessions;
- The plenary room (Saal 2) will be retransmitted in another room (Saal 4) throughout the whole meeting, in order to allow enough space for the participants;
- Participants are asked to respect as much as possible the distances when entering and leaving the rooms. Please, keep your right;
- A hostess will pass the microphone to the assembly in case of questions, and clean it between questions.

### Personal data

- The organisation ask for the contact details of the participants & exhibitors so that the chain of contamination can be traced if necessary.

# General information

## Congress venue

Kultur & Kongresshaus Aarau  
Schlosspl. 9, 5000 Aarau  
www.kuk-aaarau.ch

## Registration & Congress secretariat

Meeting.com Congress Organisation  
Rue des Pâquis 1 • CP 100  
CH-1053 Cheseaux-sur-Lausanne  
T 021 312 92 61 • F 021 312 92 63  
nicole.giacomini@meeting-com.ch



Online registration on  
[www.meeting-com.ch](http://www.meeting-com.ch) Conferences&Meetings  
Onsite registration also possible (onsite fee)

## Registration fees

### HALF-DAY POST-GRADUATE COURSE FOR JUNIOR RESIDENTS IN TRAINING Thursday, November 12

Participant

	Early fee (before Sept 30, 2020)	Late fee & onsite (as of Oct 1, 2020)
Participant	free of charge	

### SGPATH ANNUAL MEETING Thursday, November 12 as from 13.00 - Saturday, November 14, 2020

	Early fee (before Sept 30, 2020)	Late fee & onsite (as of Oct 1, 2020)
Residents/students/technicians	180.00	220.00
SSPath members	280.00	320.00
SSPath non-members	330.00	350.00

### SLIDE SEMINAR ONLY Saturday, November 14, 2020

SSPath members	free of charge	
SSPath non-members	100.00	

### CONGRESS DINNER

**FRIDAY, 13.11.2020**  
Hotel Kettenbrücke, Zollrain 16, 5000 Aarau  
80.00 (VAT incl.)

## Included in registration fee

Access to the half-day post-graduate course & the congress, certificate of attendance, badge, coffee-breaks & lunches. The congress dinner is NOT included and must be registered separately (as above)

## Payment/confirmation

After your registration/payment you will receive our invoice/confirmation by e-mail to the address given by the registration.

## Certificate of attendance

The certificate of attendance will be sent by email to all participants (slide seminars included) after the event.

## Cancellation

Written notification is required for all cancellations and changes. In case of cancellation 30 days prior the event, the refund of the amount paid will be done net of CH 60.00 for administrative costs. Thereafter no refund is possible. Any registration made within the "early bird" time must be paid. During this period, if not the case, the invoice is automatically updated at the current price. Administrative costs will be charged to no shows. Legal jurisdiction is Lausanne.

## Oral presentations E-Poster sessions

2 free paper presentation sessions  
3 moderated E-poster sessions  
- on Thursday 12.11.20 at 15:00  
- on Friday 13.11.20 at 09:30 and at 15:30

## Slide seminars

2 slide seminars  
- on Saturday 14.11.20 at 10:15 and 11:45

## Language

The language of the congress is English.

## Award Prizes

Prizes for best E-poster presentations will be granted during the Award ceremony at the congress dinner on Friday 23.11.20 at 19:15.

## CME Credits

Credit points on demand to the Swiss Society of Pathology  
**Half-day post graduate course for residents in training Pathology annual congress**  
- Thursday, 13.11.20  
- Friday, 14.11.20  
- Saturday, 15.11.20 (slide seminars included)  
- & credits for rendering diagnoses

# Program at a glance

Thursday, November 12

From 08.00

Registration & welcome coffee

09.00-10.30

Half-day post-graduate course for residents in training

Saal 2 & Saal 4

10.30-11.00

Coffee break

Foyer

11.00-12.00

Half-day post-graduate course for residents in training

Saal 2 & Saal 4

12.00-13.00

Lunch snack

Exhibition area

13.00-13.30

Opening and welcome

Saal 2 & Saal 4

13.30-15.00

DIGITAL PATHOLOGY / ARTIFICIAL INTELLIGENCE

Saal 2 & Saal 4

14.40-15.00

SESSION 1 - 2 FREE PAPER PRESENTATIONS

Saal 2 & Saal 4

15.00-16.00

E-POSTER SESSION 1

Saal 4

15.00-16.00

Coffee break - visit of the exhibition

Exhibition area

16.00-17.30

UROPATHOLOGY I BLADDER/KIDNEY

Saal 2 & Saal 4

17.30-18.00

SESSION 2 - 3 FREE PAPER PRESENTATIONS

Saal 2 & Saal 4

18.15-19.15

Meeting of the Institute Directors

Saal 4

E-poster viewing in the E-poster area during the whole day

Retransmission from saal 2 to saal 4 the whole day, in order to keep distances

Astrazeneca

# Program at a glance

## Friday, November 13

From 07.00

Registration & welcome coffee

08.00-09.30

SPECIAL SESSION COVID-19

Saal 2 & Saal 4

09.30-10.30

E-POSTER SESSION 2

Saal 4

09.30-10.30

Coffee break - visit of the exhibition

Exhibition area

10.30-12.30

BONE MARROW

Saal 2 & Saal 4

12.30-13.00

Meeting of the Swiss Society of Molecular Pathology

Saal 4

12.30-14.00

Lunch snack

Exhibition area

14.00-15.30

UROPATHOLOGY II PROSTATE/TESTIS

Saal 2 & Saal 4

15.30-16.30

E-POSTER SESSION 3

Saal 4

15.30-16.30

Coffee break - visit of the exhibition

Exhibition area

16.30-18.00

UPDATE WHO 2020 CLASSIFICATION OF  
SOFT TISSUE AND BONE TUMORS

Saal 2 & Saal 4

CONGRESS DINNER & AWARD CEREMONY

19.15 Aperitif

20.00 Dinner & Award Ceremony

Hotel Kettenbrücke

Zolliwil 15, 5000 Aarau

E-poster viewing in the E-poster area during the whole day

Retransmission from saal 2 to saal 4 the whole day, in order to keep distances

# Program at a glance

## Saturday, November 14

From 08.00

Registration & welcome coffee

08.30-10.00

General Assembly SGPath

Saal 2 & Saal 4

10.00-10.15

Coffee break

Foye

10.15-11.30

SLIDE SEMINAR I

THE CASE I NEVER FORGET (5 cases)

Saal 2 & Saal 4

11.30-11.45

Short break

Foye

11.45-13.00

SLIDE SEMINAR II

THE CASE I NEVER FORGET (5 cases)

Saal 2 & Saal 4

13.30

End of the Annual Meeting 2020

Retransmission from saal 2 to saal 4 the whole morning, in order to keep distances



**From 08.00**

Registration & welcome coffee

**09.00-10.30**

**HALF DAY POST-GRADUATE COURSE FOR RESIDENTS IN TRAINING ESSENTIALS IN PROSTATE BIOPSY INTERPRETATION**

Glen Kristiansen, Bonn (DE); Rainer Grobholz, Aarau

Saal 2  
& Saal 4

**10.30-11.00**

Coffee break

Foyer

**11.00-12.00**

**HALF DAY POST-GRADUATE COURSE FOR RESIDENTS IN TRAINING ESSENTIALS IN PROSTATE BIOPSY INTERPRETATION**

Glen Kristiansen, Bonn (DE); Rainer Grobholz, Aarau

Saal 2  
& Saal 4

**12.00-13.00**

Lunch snack

Exhibition area

**13.00-13.30**

**Official opening and welcome**

Jean-Pierre Gallati, Gesundheitsdirektor Aarau  
Dr Hansoeter Hilfiker, Stadtpräsident Aarau  
Dr Robert Rhiner (CEO KSA) Aarau  
Rainer Grobholz, Congress President, Aarau

Saal 2  
& Saal 4

**13.30-15.00**

**DIGITAL PATHOLOGY / ARTIFICIAL INTELLIGENCE**

Chairs: Intri Zlobec, Bern; Andrew Janowczyk, Lausanne



Saal 2  
& Saal 4

**13.30-14.00**

**AI - Is it ready for the clinic?**

Liron Pantanowitz, Michigan (US)

**14.00-14.20**

**Next Generation Digital Pathology - Has the future begun?**

Christian Schürch

**14.20-14.40**

**The Geneva Experience of Digital Pathology**

Doron Merkler, Geneva

**14.40-15.00**

**FREE PAPER PRESENTATIONS - SESSION 1**

Chairs: Kirsten Mertz, Liestal; Milo Frattini, Locarno

Saal  
& Saal

**14.40-14.50**

**01 Quick Annotator: an open source digital pathology tool for annotating objects 70 times faster than manual annotation**  
R. Miao, R. Toth, A. Madabhushi, A. Janowczyk, Cleveland/USA, Dover/USA, Lausanne

**14.50-15.00**

**02 Prevalence of MET Exon 14 mutations or MET amplification in non-small cell lung cancer in Swiss patients**  
S. Savic Prince, M. Bihl, M. Matter, N. Zellweger, S. Rothschild, L. Bubendorf, Basel

**15.00-16.00**

**E-POSTER SESSION 1 (P1 - P7)**

Chairs: Ellen Obermann, Lucerne; Peter Karl Bode, Zurich

Saal

**15.00-16.00**

Coffee break - Visit of the exhibition

Exhibition area

**16.00-17.30**

**UROPATHOLOGY I BLADDER/KIDNEY**

Chairs: Jean-Christophe Tille, Geneva; Achim Fleischmann, Münsterlingen

Saal  
& Saal

**16.00-16.30**

**Molecular bladder tumor classification - is it ready for daily business?**

Eva Comperat, Paris (F)

**16.30-17.00**

**Kidney tumor biopsies: How much can we get out of nothing?**

Holger Moch, Zurich

**17.00-17.30**

**Classification framework of urogenital neuroendocrine neoplasms**

Stefano La Rosa, Lausanne

17.30-18.00

**FREE PAPER PRESENTATIONS - SESSION 2**

Chairs: Wolfram Jochum, St. Gallen; Ekkehard Hewer, Lausanne

Saal 2  
& Saal 4

17.30-17.40

**03 The histologic presentation of hepatitis E reflects patients' immune status and pre-existing liver condition**

D. Lenggenhager, S. Pawel, H. Honcharova-Biletska, K. Evert, J. Wenzel, M. Montani, E. Furrer, M. Fraga, D. Moradpour, C. Sempoux, A. Weber. Zürich, Regensburg/D, Bern, Lausanne

17.40-17.50

**04 Two distinct immunopathological profiles in autopsy lungs of COVID-19**

V. Kolzer, R. Nienhold, Y. Ciani, A. Tzankov, J. Haslbauer, T. Menter, N. Schwab, M. Henkel, A. Frank, V. Zsikla, N. Willi, W. Kempf, H. Hoyler, M. Barbareschi, H. Moch, M. Tolnay, G. Cathomas, F. Demichelis, T. Junt, K. Mertz, Zürich, Basel, Trento, Liestal

17.50-18.00

**05 Development of a novel custom Next Generation Sequencing panel to facilitate diagnosis and tumor classification of salivary gland neoplasms**

S. Freiberger, M. Brada, C. Fritz, M. Broglie, T. Rordorf, G. Morand, N. Rupp, Zürich

18.15-19.15

Meeting of the Institute Directors

Saal 4

From 07.00

Registration & welcome coffee

Foyer

08.00-09.30

**SPECIAL SESSION COVID-19**

Chairs: Gieri Cathomas, Liestal; Rainer Grobholz, Aarau



Saal  
& Saal

08.00-08.30

**Virology - Demystified - the SARS-CoV-2 virus**

Volker Thiel, Bern

08.30-09.00

**Pathology - Looking inside COVID-19: Results from the Autopsies**

Alexandar Tzankov, Basel

09.00-09.30

**Public Health - Challenges to overcome and manage a pandemic**

Daniel Koch, Bern

09.30-10.30

**E-POSTER SESSION 2 (P8 - P14)**

Chairs: Philip Went, Chur; Alex Soitermann, Neuchatel

Saal

09.30-10.30

Coffee break - Visit of the exhibition

Exhibition area

10.30-12.30

**BONE MARROW**

Chairs: Stefan Dirrhofer, Basel; Yara Banz, Bern

Saal  
& Saal

10.30-11.00

**Plasma cells in the bone marrow - not always a myeloma!**

Stefan Dirrhofer, Basel

11.00-11.30

**The differential diagnosis of lymphoid infiltrates in the bone marrow**

Laurence de Leval, Lausanne

11.30-12.00

**MDS: Diagnosis and differential diagnosis**

Falko Fend, Tübingen (DE)

12.00-12.30

**MPN: Diagnosis, Subtypes and Mimics**

Michael Kvasnicka, Wuppertal (DE)

**12.30-13.00**  
**Meeting of the Swiss Society of Molecular Pathology** Saal 4

**12.30-14.00**  
 Lunch break - visit of the exhibition Exhibition area

**14.00-15.30**  
**UROPATHOLOGY II PROSTATE/TESTIS** Saal 2  
 Chairs: Lukas Bubendorf, Basel; Stefano La Rosa, Lausanne & Saal 4

**14.00-14.30**  
**Gleason score revisited: What's new after the ISUP consensus conference 2019?**  
 Glen Kristiansen, Bonn (DE)

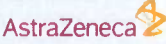
**14.30-15.00**  
**Prostate cancer in the era of personalized medicine**  
 Mark Rubin, Bern 

**15.00-15.30**  
**Germ cell tumors of the testis and ovaries - where are the differences?**  
 Daniel Berney, GB

**15.30-16.30**  
**E-POSTER SESSION 3 (P15 - P20)** Saal 4  
 Chairs: Marianne Tinguely Zurich; Tatjana Vlainic, Basel

**15.30-16.30**  
 Coffee break - Visit of the exhibition Exhibition area

**16.30-18.00**  
**UPDATED WHO 2020 CLASSIFICATION OF SOFT TISSUE AND BONE TUMORS** Saal & Saal  
 Chairs: Sylvia Höller, Zürich; Carole Gengler, Lausanne

**16.30-17.00**  
**WHO 2020 - new fusion-related mesenchymal soft tissue tumor entities**  
 Angelo Paolo Dei Tos, Padova (IT)

**17.00-17.30**  
**Nomenclature of Soft Tissue Tumors - quo vadis?**  
 Beata Bode-Lesniewska, Zurich

**17.30-18.00**  
**WHO 2020 - what's new in bone tumors?**  
 Daniel Baumhoer, Basel

**CONGRESS DINNER & AWARD CEREMONY** Hotel KETTENBRÜCKE AARAU  
 19.15 Aperitif  
 20.00 Dinner & Award Ceremony

**From 08.00**

Registration & welcome coffee

Foyer

**08.30-10.00**

**GENERAL ASSEMBLY SGPath**

Saal 2  
& Saal 4

**10.00-10.15**

Coffee break

Foyer

**10.15-11.30**

**SLIDE SEMINAR 1**

Chairs: Heather Dawson, Bern; tbd

Saal 2  
& Saal 4

**THE CASE I NEVER FORGET (5 cases)**

Eva Comperat, Paris (2 cases)  
Beata Bode, Zurich (2 cases)  
Alex Tzankov, Basel (1 case)

**11.30-11.45**

Short break

Foyer

**11.45-13.00**

**SLIDE SEMINAR 2**

Chairs: Heather Dawson, Bern; tbd

Saal 2  
& Saal 4

**THE CASE I NEVER FORGET (5 cases)**

Luca Mazzucchelli, Locarno (2 cases)  
Aurel Perren, Bern (1 case)  
Laurence de Leval, Lausanne (1 case)  
Paul Komminoth, Zurich (1 case)

**13.00**

End of the Annual Meeting 2020



**Dr. Daniel Koch** is now working as an independent crisis management and communications consultant (since June 2020). He became a familiar and popular personality throughout Switzerland

due to his assignment to the management of the Corona pandemic and his active participation in the media as the COVID-19 delegate of the Swiss Federal Office for Public Health, and as the head of the FOH's Communicable Disease Division. Daniel Koch studied medicine at the University of Berne and completed his postgraduate studies in public health at the Johns Hopkins University in Baltimore. He held several positions at the ICRC for over 14 years (amongst others as medical coordinator in various conflict zones) before joining the FOH in 2002 where he worked in various departments. He was also a member of the SARS pandemic and the H5N1 avian flu Task Forces.



**Volker Thiel** has studied Biology at the University of Würzburg, Germany. Already during his master thesis he started to work on coronaviruses at the Institute of Virology in Würzburg and has then completed his PhD in 1998. One of the major achievements is the establishment of reverse

genetics system for various coronaviruses, including Human Coronavirus 229E, SARS-CoV and SARS-CoV-2 and he was the first to report a molecule clone for a human coronavirus. In 2000 he moved to the Kanton Hospital in St. Gallen where he was leading a research group at the Institute of Immunobiology. He habilitated in Virology at the Vetsuisse Faculty in Zürich and moved in 2014 to the University of Bern where he is Professor and chair in Virology at the Vetsuisse Faculty Bern and head of the division Virology at the Institute of Virology and Immunology (IVI).

**BAUMHOER Daniel Prof.**

Institute of Medical Genetics and Pathology, University Hospital Basel, Basel

**BERNEY Daniel Prof.**

Centre for Molecular Oncology, Barts Cancer Institute, Charterhouse Square, Queen Mary University of London, London (GB)

**BODE-LESNIEWSKA Beata Prof.**

Pathologie Enge, Zurich

**COMPERAT Eva Prof.**

Service d'Anatomie- Pathologique Hopital Tenon, 4, Rue de la Chine, 75020 Paris, Paris (F)

**DE LEVAL Laurence Prof.**

Institute of Pathology, Lausanne University Hospital (CHUV), Lausanne

**DEI TOS Angelo Paolo Prof.**

Università degli Studi di Padova, Dept of Oncology and Pathology, Padova (I)

**DIRNHOFER Stefan Prof.**

Institute of Medical Genetics and Pathology, University Hospital Basel, Basel

**FEND Falko Prof.**

Institute of Pathology and Neuropathology and Comprehensive Cancer Center, University Hospital Tübingen, Tübingen (D)

**GALLATI Jean-Pierre Mr.**

Regierungsrat, Departement Gesundheit und Soziales, Kanton Aargau, Aarau

**GROBHOLZ Rainer Prof.**

Institute of Pathology, Kantonsspital Aarau AG, Aarau

**HILFIKER Hanspeter Dr.**

Stadtoräsident, Stadt Aarau, Aarau

**KOCH Daniel Dr.**

Independent crisis management and communications consultant, Bern

**KRISTIANSEN Glen Prof.**

Department of Pathology, University Hospital Bonn, Bonn (D)

**KVASNICKA Hans Michael Prof.**

Institute of Pathology and Department of Molecular Pathology, Helios University Clinic Wuppertal, University of Witten/Herdecke, Wuppertal (D)

**LA ROSA Stefano Prof.**

Institute of Pathology, Lausanne University Hospital (CHUV), Lausanne

**MERKLER Doron Prof.**

Department of Pathology and Immunology, University of Geneva, Division of Clinical Pathology, Geneva University Hospital, Geneva

**MOCH Holger Prof.**

Institute of Pathology and Molecular Pathology, University Hospital Zurich, Zurich

**PANTANOWITZ Liron Prof.**

Department of Pathology, University of Michigan, Ann Arbor (USA)

**RHINER Robert Dr.**

CEO, Kantonsspital Aarau AG, Aarau

**RUBIN Mark Prof.**

Department for Biomedical Research, University of Bern and Bern Center for Precision Medicine, Bern

**SCHÜRCH Christian M. MD-PhD**

Department of Microbiology and Immunology, Stanford University School of Medicine, Stanford, CA, Stanford (USA)

**THIEL Volker Prof.**

Institute of Virology and Immunology (IVI); Department of Infectious Diseases and Pathobiology, Vetsuisse Faculty, University of Bern, Bern

**TZANKOV Alexandar Prof.**

Institute of Medical Genetics and Pathology, University Hospital Basel, Basel

P 1

Retrospective post-mortem SARS-CoV-2 RT-PCR of autopsies with COVID-19 suggestive pathology supports absence of lethal community spread in Basel, Switzerland before February 2020

H. Jasmin, V. Perrina, M. S. Matter, A. Dellas, M. Mihatsch, A. Tzankov; Basel

P 2

An in-depth characterization of cardiac pathology in lethal COVID-19

H. Jasmin, A. Tzankov, K. D. Mertz, N. Schwab, R. Nienhold, R. Twerenbold, G. Leibundgut, A.K. Stalder, M. S. Matter, K. Glatz; Basel, Liestal

P 3

SARS-CoV-2 virus detection in tissues by reverse transcriptase quantitative PCR: set-up of a methodology suitable for FFPE samples

K. Lefort, D. Maison, S. Berezowska, N. Piazzon, L. de Leval, B. Bisig; Lausanne

P 4

Mutational landscape of marginal zone B-cell lymphomas of various origin: organotypic pathways and diagnostic potential for organ assignement

V. Vela, D. Juskevicius, T. Menter, V. Pillonel, S. Drinhofer, A. Tzankov; Basel

P 5

Quality Comparison of Computer-assisted T-cell and Tumor-Bud Detection in pT1 Colorectal Cancer from Four Different Pathology Institutions (*Student paper*)

L. Studer, J.-M. Bokhorst, I. Zlobec, A. Lugli, A. Fischer, F. Ciompi, J. van der Laak, I. Nagtegaal, H. Dawson, Freiburg, Nijmegen, Basel, Bern

P 6

PatchSorter: a high throughput digital pathology tool for cell labeling

T. Talawalla, A. Madabhushi, A. Janowczyk; Cleveland, Lausanne

P 7

Mutational profiles of primary pulmonary adenocarcinomas and paired brain metastases

S. Berezowska, E. Kashani P. Zens, A. Kündig C. Fung, A. Scherz, E. Herrmann, E. Ermis, R. A. Schmid, E. Vassella; Lausanne, Bern

P 8

Putative malignant pleural mesothelioma in situ (MPMIS) with sequential acquisition of genomic alterations on fluorescence in situ hybridization (FISH) examination

S. Haefliger, S. Savic Prince, H. Borer, J. Rebetez, L. Bubendorf; Basel, Solothurn

P 9

Progressive Disease in Sentinel-negative Melanoma Patients: Biological Differences and Importance of Sentinel Lymph Node Biopsy

A. Conrad, U. Maccio', M. Reinehr, D. Holzmann, J. Mangana, M. Wanner, M. Huellner, R. Barnhill, C. Lugassy, N. Lindenblatt, D. Mihic-Probst; Zurich, Paris

P 10

Diffuse pulmonary meningotheliomatosis. A case report of a rare disease

R. Zweifel, B. Hartmann, S. Rusch, F. Gambazzi, R. Grobholz; Aarau

P 11

Impact of extracellular mucin detection in colorectal cancer using a novel unsupervised deep learning method

H.G. Nguyen, A. Blank, H. Dawson, A. Lugli, I. Zlobec; Bern, Basel

P 12

Postmortem pulmonary pathology and virus detection in patients with COVID-19 infection: single-center report of 12 consecutive autopsies from Lausanne, Switzerland

S. Berezowska, K. Lefort, K. Ioannidou, D. Ndiaye, K. Petrovas, C.-Y. Tsai, D. Milowich, E. Multone, N. Sala, B. Bisig, L. de Leval; Lausanne

P 13

Metastases in hepatocellular carcinoma retain morphology but show difference in methylation profile

S. Haefliger, C. Rourke, J. Andersen, M. S. Matter; Basel, Copenhagen

P 14

Posttransplant EBV-negative diffuse large B-cell lymphoma with microsatellite instability: an unexpected finding revealed by NGS

N. Dattner, E. Missiaglia, A. Letourneau, M. Pascual, D. Golshayan, L. de Leval, B. Bisig; Lausanne

P 15

Automatic detection of h.pylori in gastric biopsies (*Student paper*)

T. Ogi, I. Zlobec, H.G. Nguyen, B. Dislich; Bern

P 16

Superior survival prediction using a combined score of major pathological response, ypT and ypN compared to the standard TNM model in non-small cell lung cancer after neoadjuvant therapy (*Student paper*)

P. Zens, C. Bello, A. Scherz, J. Koenigsdorf, A. Pöllinger, R. A. Schmid, A. Ochsenbein, C. Neppi R. Langer, S. Berezowska; Bern, Linz, Lausanne

P 17

Significance of Tumor regression in lymph node metastases of esophageal adenocarcinomas after neoadjuvant therapy (*Student paper*)

M. M. Osecky, R. Langer, B. Dislich, K. Becker, M. Feith, D. Kröll; Bern, Munich

P 18

Immunohistochemistry for SARS-CoV-2 in Autoptic Pulmonary Tissue

N. Schwab, R. Nienhold, J. Haslbauer, M. Sachs, N. Willi, M. S. Matter, A. Tzankov, K. Mertz, G. Cathomas; Liestal, Basel

P 19

Effects of Multiple Scanners on Deep Learning based Lymph Node Segmentation in Histopathology Images (*Student paper*)

A. Khan, A. Blank, F. Müller, H. G. Nguyen, A. Lugli, H. Dawson, J.-P. Thiran, I. Zlobec; Bern, Lausanne

P20

Self-supervised learning for weakly labelled data in colorectal cancer (*Student paper*)

C. Abbet, L. Studer, I. Zlobec, B. Bozorgtabar, J.-P. Thiran; Lausanne, Fribourg, Basel

1. LABFORCE
2. INSPIRATA
3. SYSMEX
4. MSD
5. ELLI LILLY
6. ROCHE DIAGNOSTICS
7. BIOSYSTEMS
8. RUWAG
9. PRECIPPOINT
10. IVDICALABS
11. UNILABS
12. OLYMPUS
13. HAMAMATSU
14. AGILENT
15. BASYS DATA
16. BIOCARTIS
17. CARL ZEISS
18. HISTOCOM
19. AXONLAB
20. NOVARTIS
21. BÜHLMANN
22. PRÖMEGA
23. MEDITE

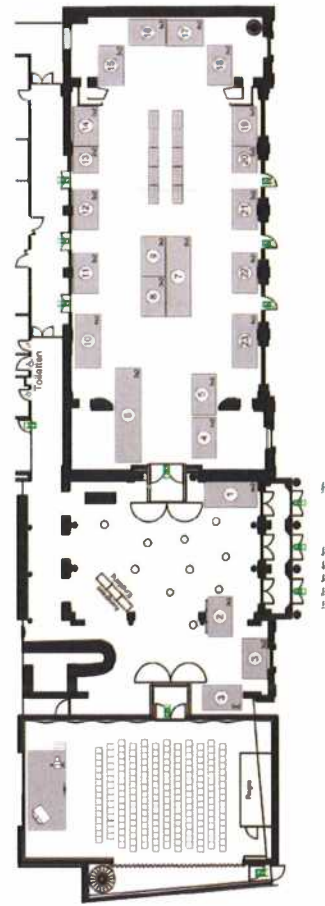

AstraZeneca 

*Lilly*

 Roche

Il s'agit d'un soutien d'une presentation sur la base du programme scientifique, le sponsor n'a pas d'influence ni sur le contenu ni sur le choix de l'orateur (responsabilité de la SGPath).

Es handelt sich um eine finanzielle Unterstützung für einen Vortrag auf der Grundlage des wissenschaftlichen Programms. Der Sponsor hat keinerlei Einfluss auf den Inhalt oder auf die Wahl des Referenten, dieses obliegt alleine der SGPath.

It is a financial support of a conference based on the scientific program, the sponsor has no influence on the content, nor on the choice of the speaker (responsibility of the SGPath).



Kind thanks to all our sponsors



BIOCARTIS



PRECIPOINT



Save the date

2021

**SWISS PATHOLOGY DAYS**  
87th ANNUAL CONGRESS  
of the Swiss Society of Pathology

Thursday 11 - Friday 12 - Saturday 13 November 2021

Kultur- und Kongresszentrum Thun KKTHUN  
Seestrasse 68, 3602 Thun



# REThink biomarker testing

References:

1. Dhillon A, et al. Targeting RET-driven cancers: lessons from evolving preclinical and clinical landscapes. *Mol Rev Clin Oncol*. 2018;15:151-162.
2. Agrawal S, et al. Molecular pathology of thyroid tumors of follicular cells: a review of genetic alterations and their Genetopathological relevance. *Thyroid*. 2018;28:115-31.
3. Campi R, et al. Genetic landscape of somatic mutations in a large cohort of sporadic metastatic thyroid carcinomas studied by next-generation targeted sequencing. *IScience*. 2019;20: 234-56.

Copyright © Lilly, LLC. All Rights Reserved.  
PP-014-CH-021019-2020

Lilly

Fa Lilly (Suisse) SA, CH, des Coazelets 16, CP 580, 1214 Vernier (GE)



## Home-Office

Flexibles Arbeiten  
für Sie als Pathologe



### Slide-Scanner und Software für sichere und effiziente Telepathologie

Mit unseren individuellen Telepathologie-Lösungen bieten wir Ihnen schnell zu realisierende Optionen, um Gewebeproben sicher von zu Hause aus digital zu befunden. Unabhängig davon wie weit Sie bereits die Digitalisierung in Ihrem Pathologielabor umgesetzt haben – wir gehen mit Ihnen die nächsten Schritte.



Sprechen Sie  
mit gerne für ein  
unverbindliches  
Gespräch an!

[www.sysmex.ch/telepathologie](http://www.sysmex.ch/telepathologie)